

ID	Parts	Materials
1	Body I	carbon steel (option - stainless steel)
2	Body II	carbon steel (option - stainless steel)
3	Needle	chromium steel
4	Spindle	chromium steel
5	Seat ring	stainless steel
6	Soft seals	polyurethane / NBR

DRIVE TYPES

- double acting oil servo cylinder
- double acting water servo cylinder
- double acting oil / water servo cylinder
- closing by spring, opening by water/oil
- manual operated gearbox
- electrical operated gearbox

FEATURES & OPTIONS

- shut-off and regulating devices in pressurized piping systems
- installation requires 90/120 deg. bend in the pipeline
- metal-to-metal sealing system
- limit switches for close and open position
- recommended water velocity to max. 15 m/s

- for water service in temperature up to 70°C / 158°F
- no lubrication points / maintenance free

OPTIONS

- + additional hydraulic and electrical equipment
- + wiring with terminal box
- + orifice outlet plate for energy dissipation and reduction of the medium velocity

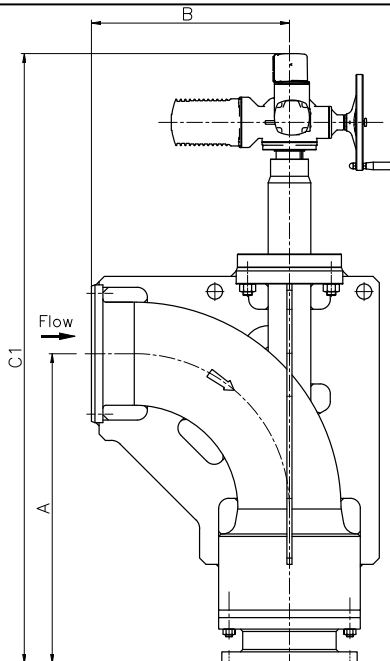

Angle 90°, electrical gearbox

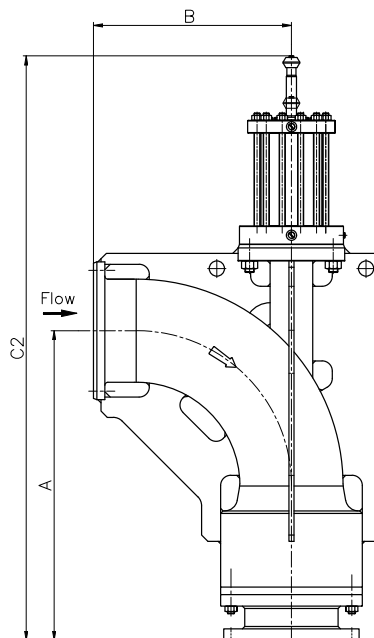

Angle 90°, servo cylinder

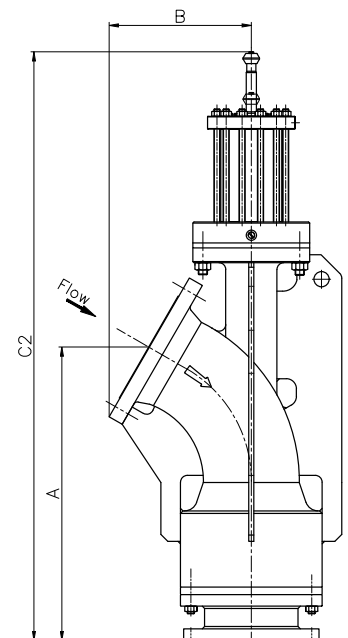

Angle 120°, servo cylinder

DN	PN6					PN10					PN16					PN25					PN40					PN63				
	A	B	C1	C2	Valve weight	A	B	C1	C2	Valve weight	A	B	C1	C2	Valve weight	A	B	C1	C2	Valve weight	A	B	C1	C2	Valve weight	A	B	C1	C2	Valve weight
[mm]	[mm]	[mm]	[mm]	[mm]	[kg]	[mm]	[mm]	[mm]	[mm]	[kg]	[mm]	[mm]	[mm]	[mm]	[kg]	[mm]	[mm]	[mm]	[mm]	[kg]	[mm]	[mm]	[mm]	[mm]	[kg]	[mm]	[mm]	[mm]	[mm]	[kg]
65	200	130	550	350	50	200	130	600	400	70	220	130	600	400	80	250	150	650	450	90	280	150	700	500	100	330	170	800	600	110
80	250	150	700	400	100	250	160	750	450	110	300	200	750	450	130	350	200	750	500	150	370	220	800	550	170	380	220	850	650	180
100	300	200	750	450	120	350	250	800	500	150	350	250	850	550	180	400	300	900	600	200	450	300	900	600	220	450	300	1300	1000	250
125	350	250	800	500	140	400	300	850	550	170	450	350	900	600	200	450	350	950	650	220	500	350	1100	800	250	500	400	1100	800	250
150	450	300	850	550	160	500	350	900	600	200	500	370	1000	700	250	550	400	1100	750	280	600	400	1200	900	300	600	450	1300	1000	400
200	550	350	900	600	180	600	400	1200	800	220	600	450	1300	900	250	650	500	1400	950	300	700	500	1600	1300	500	800	550	1650	1400	800
250	650	450	1400	1100	250	700	500	1500	1200	280	700	500	1550	1200	300	750	550	1600	1300	500	800	600	1700	1400	800	850	650	1750	1500	900
300	750	550	1500	1200	350	800	550	1550	1300	380	850	550	1600	1300	800	900	600	1700	1400	950	950	650	1800	1500	1000	1000	750	1900	1600	1200
350	1180	700	2100	1900	1100	1180	700	2100	1900	1100	1200	700	2100	1900	1150	1230	750	2200	2000	1200	1260	750	2200	2000	1250	1300	800	2250	2050	1350

Valve weights in dimensions table are given without a drive weight

Flange in accordance with EN 1092-1. ANSI and MSS flanges available on request.

Dimensions and weights are preliminary only. Final dimensions and weights are established after detail design.

Other materials are available upon request.

Painting for standard valves - two-component epoxy coating.

Drawings are schematic only.